

# INSTALLATION INSTRUCTIONS FOR EXIT DEVICE TRIM

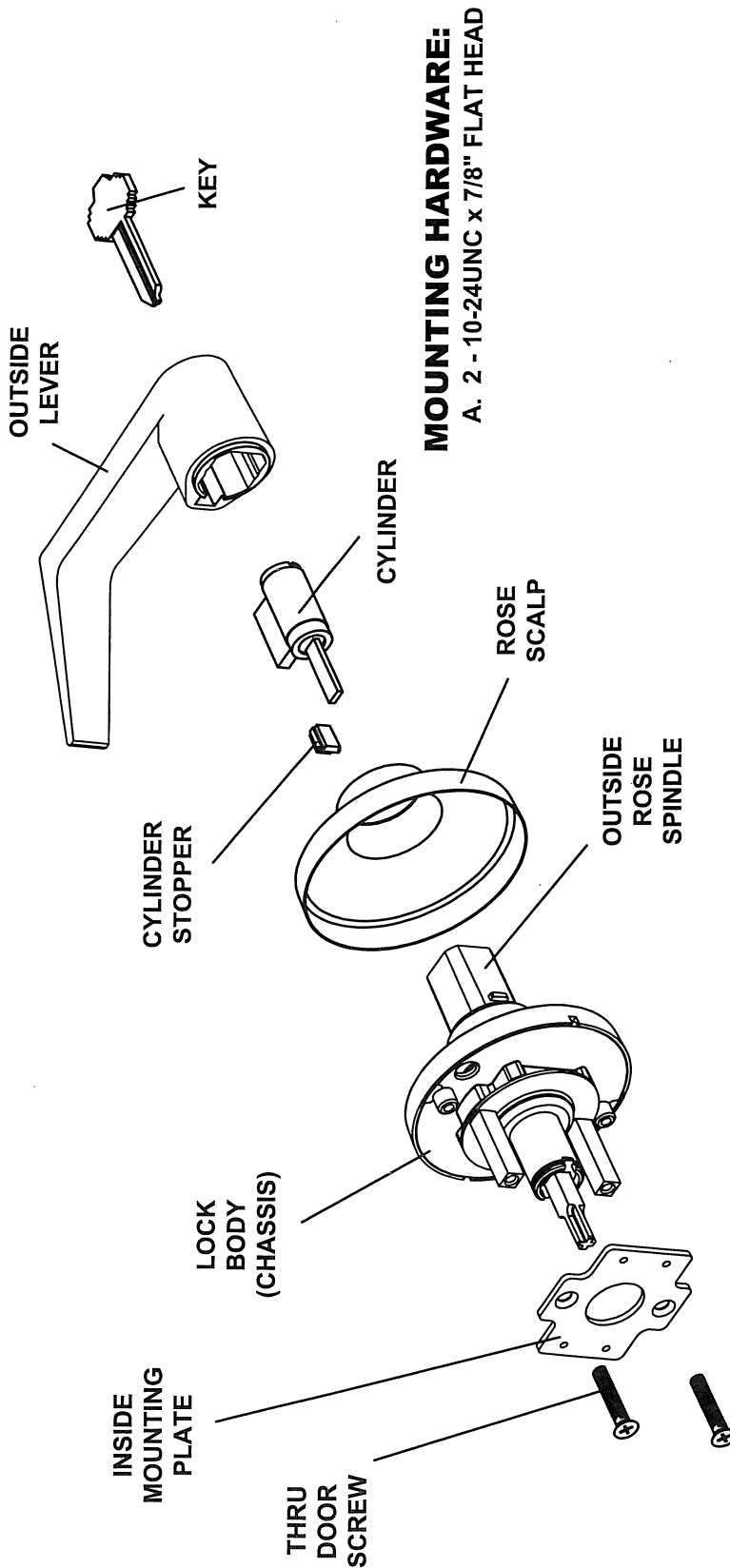

**MOUNTING HARDWARE:**  
 A. 2 - 10-24UNC x 7/8" FLAT HEAD

## 2. BORE HOLES (DOOR PREPARATION)

- A. Drill a 2 1/8" hole through door.
  - B. Drill two 5/16" holes 1/2" deep on side of door where trim will mount.
- NOTE:** A fixture is recommended for drilling the 5/16" holes.

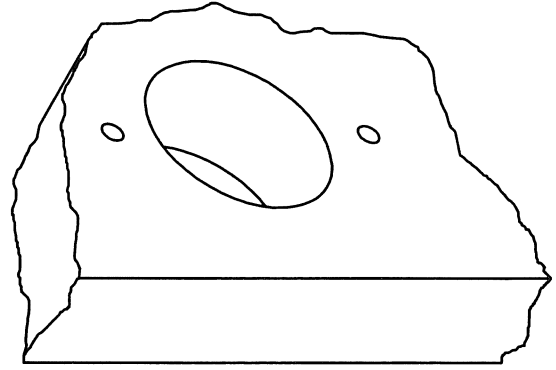

## 1. MARK DOOR

- A. Mark center point for 2-1/8" hole to match backset and height on template for exit device.
- B. Mark door for two 5/16" locating holes based on template located on the back side of this instruction sheet.

**NOTE:** Accurate door preparation is essential for proper function of this exit device trim.

# INSTRUCTIONS TO REKEY DEVICE TRIM

Does not apply to IC

## TO REMOVE CYLINDER LEVER

- Insert key into lock and rotate 45° clockwise and hold.
- Depress retainer clip with pick provided (or other pointed tool).
- Pull lever off of lock.

## TO REMOVE CYLINDER FROM LEVER

- Remove cylinder stopper.
- Slide cylinder out of lever.

## TO INSTALL CYLINDER INTO LEVER

- Slide cylinder into lever.
- Install cylinder stopper.

## TO INSTALL CYLINDER LEVER

- Slide lever down to lever retainer clip on spindle.
- Insert key into cylinder, rotate 45° clockwise and hold.
- Push in lever retainer clip and slide lever into locked position.

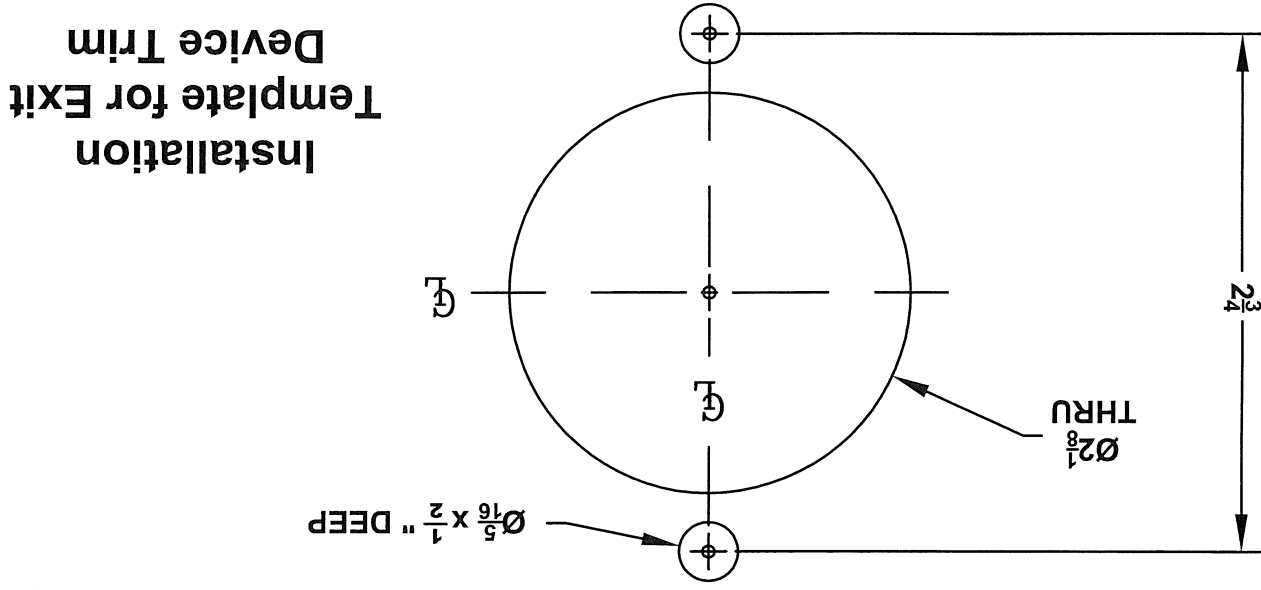
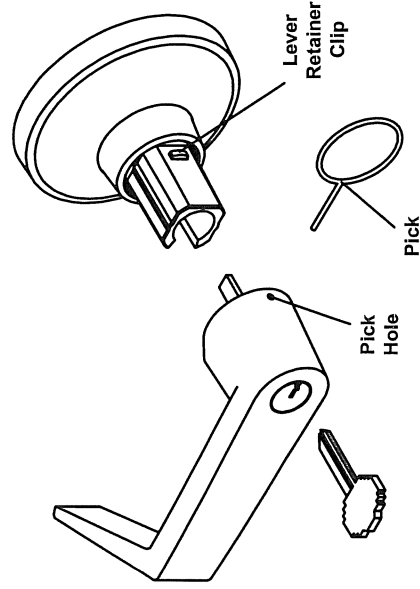

Note: Backset and Height determined by Exit Device Template

TOP