



- PIN Access
- Mechanical Pushbutton Lock
- Single Access Code
- Deadbolt/Spring Latch/Rim Deadlocking Latch
- Thumbturn

### Features

<b>Access Control:</b>	Mechanical pushbutton lock—eliminates problems and costs associated with issuing, controlling, and collecting keys and cards. Provides fully mechanical primary or auxiliary pushbutton access control by exterior combination, while allowing free egress at all times by interior thumbturn. Deadbolt models must be manually relocked. Deadlocking latch models automatically relock each time the door closes.
<b>No Battery:</b>	Fully mechanical lock eliminates the material and labor expense of battery replacements
<b>Locking Device Options:</b>	Deadbolt—must be manually relocked Deadlocking latch—relocks automatically when door closes Rim locking latch—relocks automatically when door closes; also has latch holdback
<b>Number of Codes:</b>	Single access code—one easy to manage code for all users
<b>Programming:</b>	Lock is easily programmed via keypad without removing lock from the door
<b>Handing:</b>	Field reversible
<b>Operation Modes:</b>	Single credential—access Latch holdback (7106 only)
<b>Economical:</b>	A cost effective access control solution

### Mechanical Features

<b>Construction:</b>	All metal cast front housing; force-proof, clutch-protected exterior thumbturn
<b>Numeric Keypad:</b>	Vandal resistant, solid metal pushbuttons
<b>Handing:</b>	Field reversible
<b>Finishes:</b>	<b>For all models except 7106:</b> Bright Brass 03 (605), Satin Chrome 26D (626), Antique Copper (AC) (059), Gold Vein (GV) (060), Antique White (AW) (062), Silver Vein (SV) (061), Black 19 (676), and Antique Brass 05 (609) <b>Model 7106:</b> Inside Trim (Black Only) All other models (Black), Inside Trim Satin Chrome
<b>Latch:</b>	1" (25 mm) tubular deadbolt ½" (13 mm) deadlocking latch ⅝" (16 mm) rim deadlocking latch
<b>Backset:</b>	2 ¾" (70 mm) or 2 ⅜" (60 mm) backset
<b>Strike:</b>	Models 7102 and 7108: Flat deadbolt strike plate Model 7104: Curved lip strike plate Model 7106: Box strike for in-swing doors and flat strike for out-swing doors
<b>Minimum Stile Required:</b>	4" (102 mm)
<b>Weight:</b>	2.5 lbs. (1.1 kg)

### Installation

<b>Installation:</b>	1 3/8" (35 mm) diameter through bore; 1" (25 mm) diameter cross bore; 3/4" (19 mm) through bore; 2 x 1/4" through bores
<b>Door Thickness:</b>	1 3/8" (35 mm) to 2 1/4" (57 mm), wood or metal
<b>Items Supplied Include:</b>	Installation manual, full-scale template and required installation hardware

### Certification and Testing

<b>Durability:</b>	Highly weather resistant
--------------------	--------------------------

### Warranty

<b>Warranty:</b>	1-year warranty
------------------	-----------------

### Auxiliary Lock

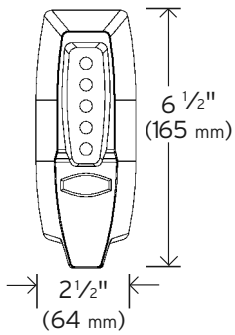

**Exterior**

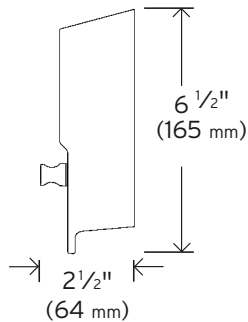

**Exterior Side**

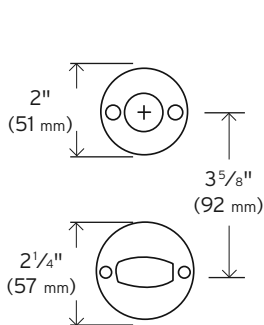

**Models 7102, 7104, 7108**

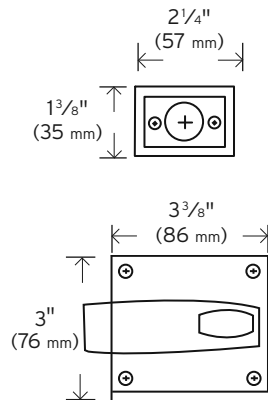

**Models 7106**

**Interior**

#### Model 7102

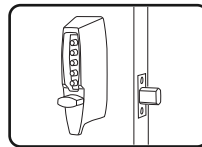

- 1" (25 mm) Tubular Deadbolt, Flat Face Plate
- Backset 2 3/4" (70 mm)
- Auxiliary Lock
- Manual Relock
- Numerous Finishes

#### Model 7104

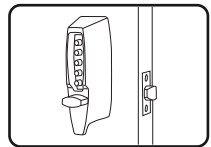

- 1/2" (13 mm) Deadlocking Latch, Flat Face Plate
- Backset 2 3/8"-2 3/4" (60-70 mm) - Adjustable
- Primary/Auxiliary Lock
- Automatic Relock
- Numerous Finishes

#### Model 7106

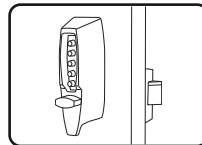

- 5/8" (16 mm) Rim Deadlocking Latch, Flat Face Plate
- Backset 2 3/8" (60 mm)
- For Wood Doors Only
- Auxiliary Lock
- Automatic Relock and Latch Holdback
- Select Finishes

#### Model 7108

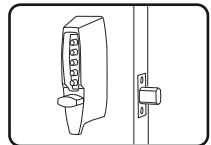

- 1" (25 mm) Tubular Deadbolt, Flat Face Plate
- Backset 2 3/8" (60 mm)
- Auxiliary Lock
- Manual Relock
- Numerous Finishes

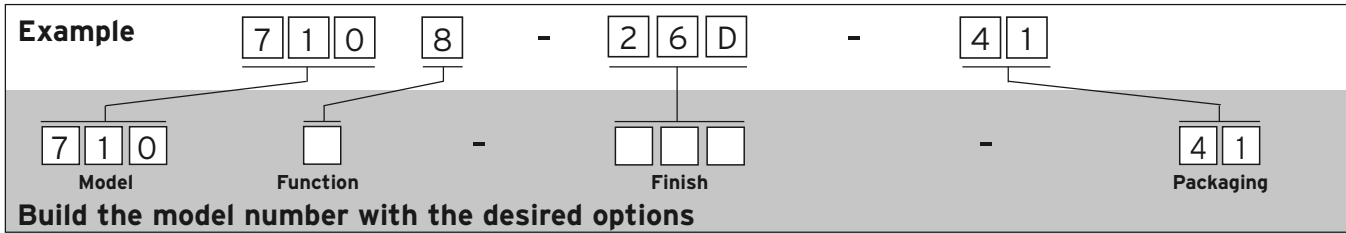

Base Model	Description
710826D41	Auxiliary Lock with Thumbturn, Deadbolt, 2 3/8" (60 mm) Backset

### Choose one option from each category

Function Options	Description
2	1" Tubular Deadbolt, flat front faceplate 2 3/4" (70 mm) backset
4	1/2" (13 mm) deadlocking latch, flat front faceplate Adjustable 2 3/8" (60 mm) to 2 3/4" (70 mm) backset
6+	5/8" Rim deadlocking latch (for wood doors only) 2 3/8" (60 mm) backset (Black or Satin Chrome Only)**
8	1" Tubular deadbolt, flat front faceplate 2 3/8" (60 mm) backset

Finish Options	Description
26D	Satin Chrome (626)
05	Antique Brass (609)
03	Bright Brass (605)
AW	Antique White (Powder Paint 062)
AC	Antique Copper (Powder Paint 051)
GV	Gold Vein (Powder Paint 060)
SV	Silver Vein (Powder Paint 061)
19**	Black (Powder Paint 676)**

### Notes

+ Automatic relock and latch holdback feature—Available in Satin Chrome or Black Only—Inside trim is black only on this model

\*\* 7106 Models Inside Trim (Black Only)—All Other Models (Black), Inside Trim (Satin Chrome)

### Simplex® 2015 Series

Model	Description
54266	Blank Keys
54266-1-11	Master Keys for key override models. (Old #54266-1) (Specify Keycut)
54266-2-11	Service Keys for override models. (Old #54266-2) (Specify Keycut)

### Simplex® 6200 Series

Model	Description
55072-03-01	Filler Plate—Bright Brass
55072-26D-01	Filler Plate—Satin Chrome
55072-19-01	Filler Plate—Black

### Simplex® 900 Series

Model	Description
800-04-41	Adapter kit for doors with metal frames. Includes riser plates and surface mounted strike. Finish 04 Satin Brass; packaged 1 per box. (Old #74464/74468)
800-26D-41	Adapter kit for doors with metal frames. Includes riser plates and surface mounted strike. Finish 26D Satin Chrome; packaged 1 per box. (Old #74464/74468)
805-26D-41	Face plate shield. Not for use with key override models. Inhibits unauthorized observation of the combination. Finish 26D Satin Chrome; packaged 1 per box. (Old #24081-000-01)
54266	Blank Keys
54266-1-11	Master Keys for key override models. (Old #54266-1) (Specify Keycut)
54266-2-11	Service Keys for key override models (Old # 54266-2) (Specify Keycut)

### Simplex® 1000, L1000 & 5000 Cores & Wrap Plates

Model	Description
204231-03-41	Wrap Plate, 10 ½" (267 mm), Bright Brass (605)
204231-05-41	Wrap Plate, 10 ½" (267 mm), Antique Brass (609)
204231-26D-41	Wrap Plate, 10 ½" (267 mm), Satin Chrome (626)
204232-03-41	Wrap Plate, 15" (381 mm), Bright Brass (605)

204232-05-41	Wrap Plate, 15" (381 mm), Antique Brass (609)
204232-26D-41	Wrap Plate, 15" (381 mm), Satin Chrome (626)
20484-03-01	Best Equivalent SFIC Bright Brass (605)
201484-05-01	Best Equivalent SFIC Satin Brass (609)
201484-26D-01	Best Equivalent SFIC Satin Chrome (626)
201600-083-01	Anti-Spy Shield (1000/L1000 Models Only)
204022-000-01	Latch Extension Assembly converts to 3¾" (10 cm) Backset
204023-000-01	Latch Extension Assembly converts to 5" (13 cm) Backset
54644-000-41	Weather Cover (smoke colored)
64754-000-01	Lubriplate Aero Grease Tubes (1.75 oz tubes) 150°F to -70°F (66°C to -57°C)
64684-26D-01	Installation Jig (1000/L1000/5000/E5000)

### Simplex® Mounts\*

Model	Description
204246-000-41	<b>LD Series—450 &amp; 470</b> Dual Mount
04083-000-41	<b>8100</b> Series
204086-000-41	<b>EE1000</b> Series
204087-000-41	<b>LP1000</b> Series
203053-000-41	<b>900</b> Series— <b>904 &amp; 919</b> Dual Mount
204189-000-41	<b>7100</b> Series— <b>7108 &amp; 7104</b> Dual Mount
204092-000-41	<b>7100</b> Series—( <b>7106</b> Series Only)
204094-000-41	<b>6200</b> Series
204096-000-41	<b>2015</b> Series
203044-000-41	<b>1000, L1000, 5000</b> Series
74378-CH	<b>3000</b> Series Narrow Stile
SP5000 ACLMT	Simplex <b>5000</b> Acrylic Mount

\* Mounts do not include locks

Hardwood product demonstration mount, packaged 1 per box.