

## BARN DOOR HARDWARE - LOW PROFILE CONCEALED WHEEL

EMTEK®

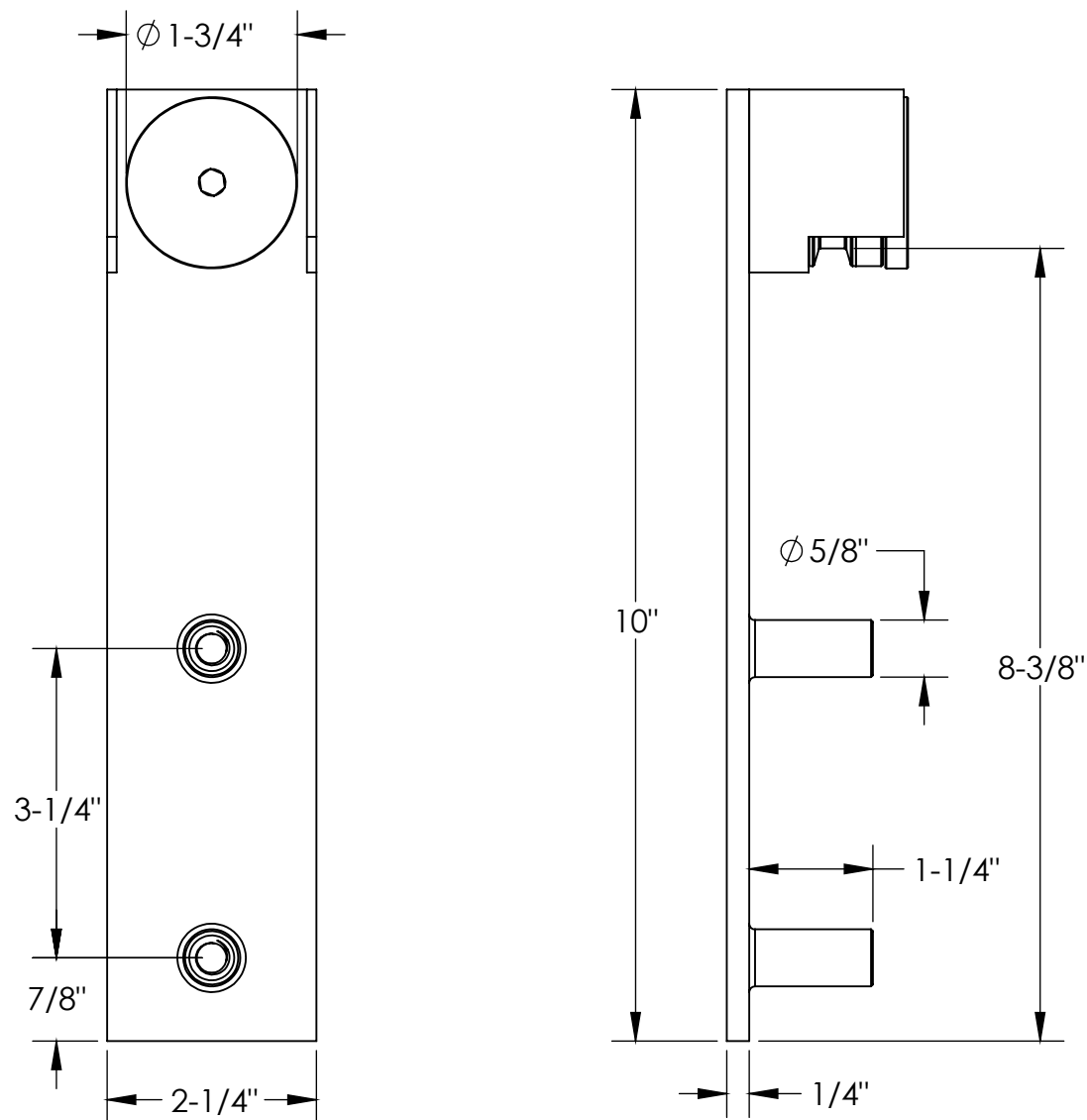

The wall or structure that your system will be mounted on must be designed to support a maximum door weight of 400 lbs.

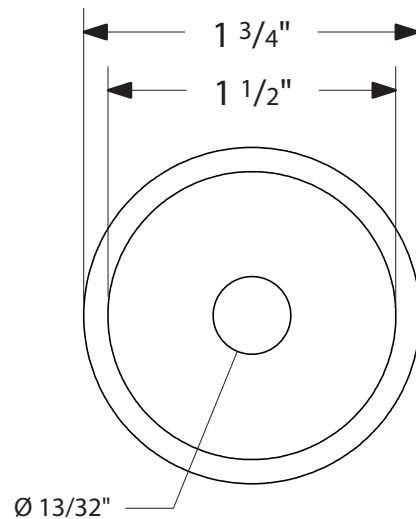

Post & Spacer

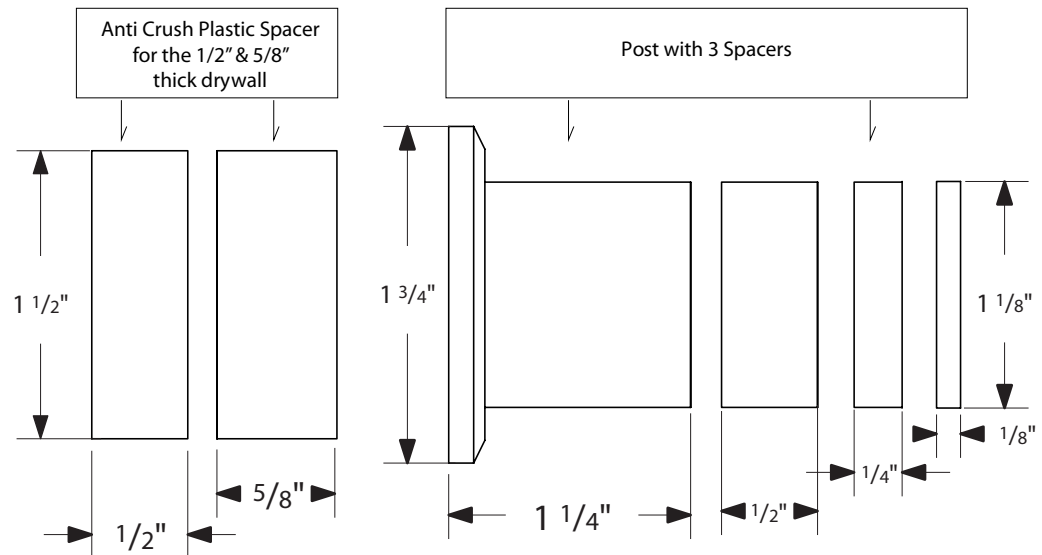

Without a counterbore, the door thickness is 1-3/8" to 2-1/4"

The wall or structure that your system will be mounted on must be designed to support a maximum door weight of 400 lbs.

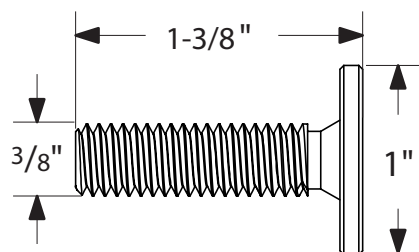

Hanger Screw

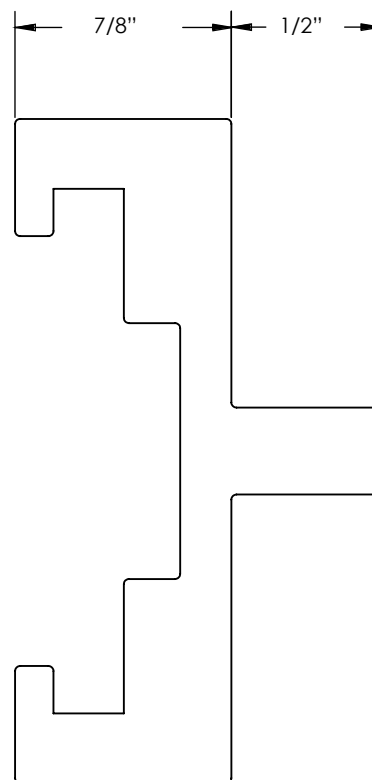

Track Stop

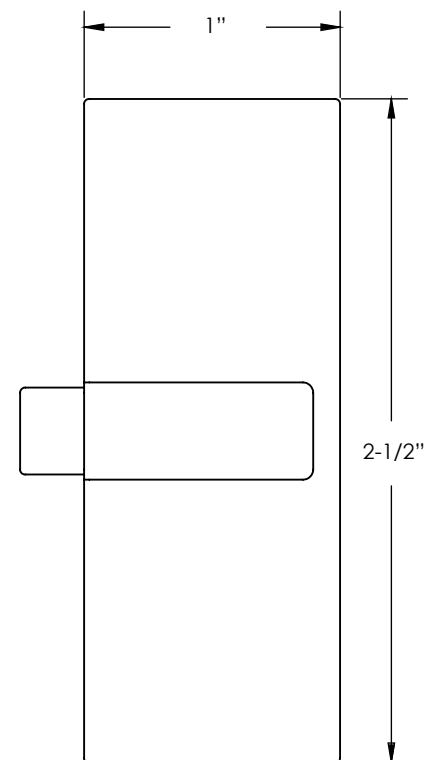

The wall or structure that your system will be mounted on must be designed to support a maximum door weight of 400 lbs.

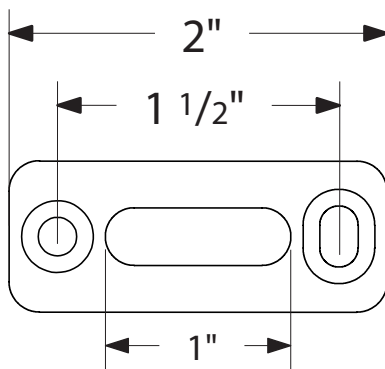

Floor Guide

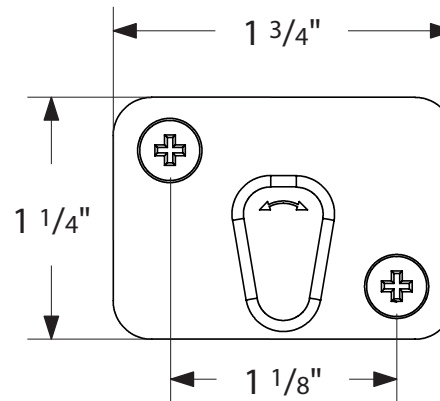
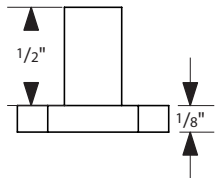

Anti-Jump

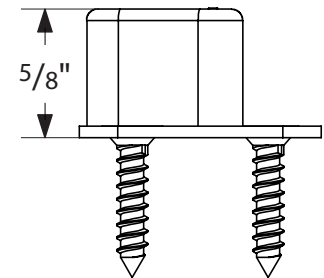

HEX 5/16 X .200 DEEP

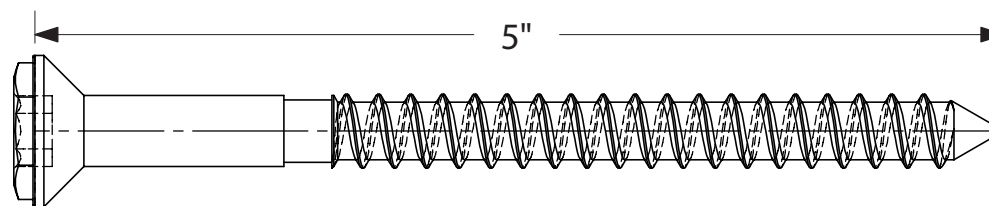
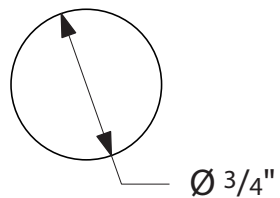

Track Screw

The wall or structure that your system will be mounted on must be designed to support a maximum door weight of 400 lbs.

## BARN DOOR HARDWARE - LOW PROFILE CONCEALED WHEEL

EMTEK®

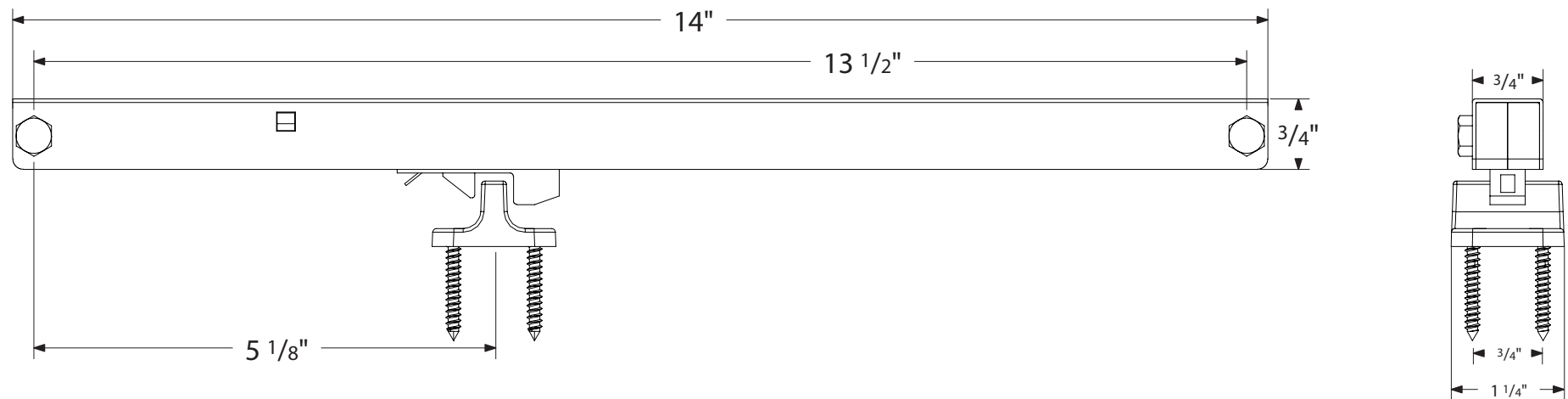

The wall or structure that your system will be mounted on must be designed to support a maximum door weight of 400 lbs.

# BARN DOOR HARDWARE - LOW PROFILE CONCEALED WHEEL

EMTEK®

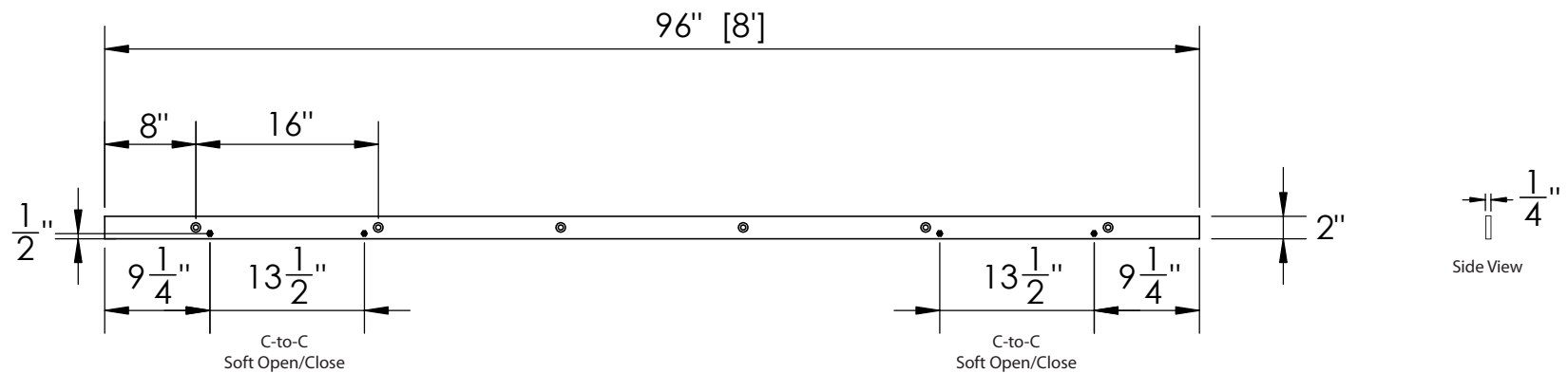
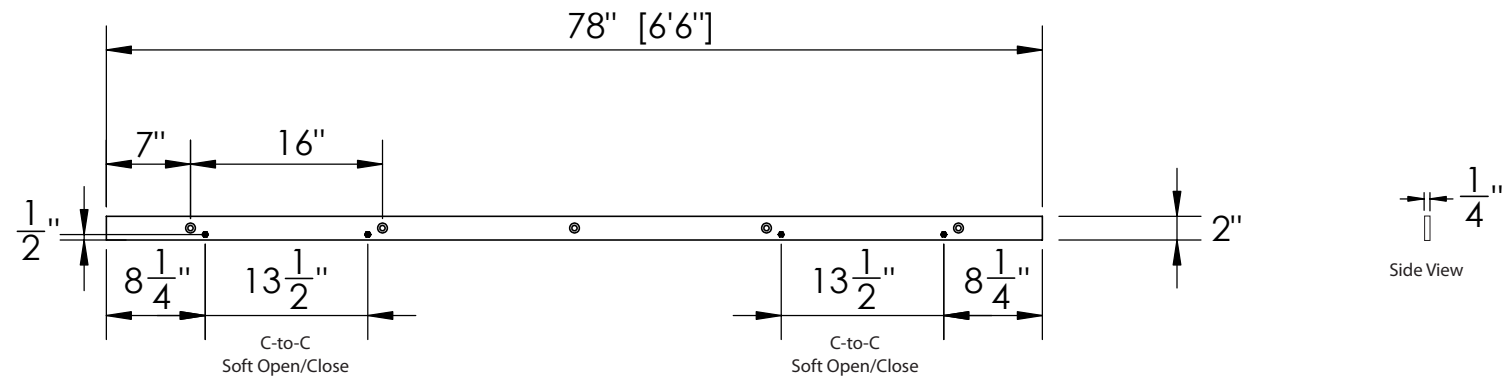
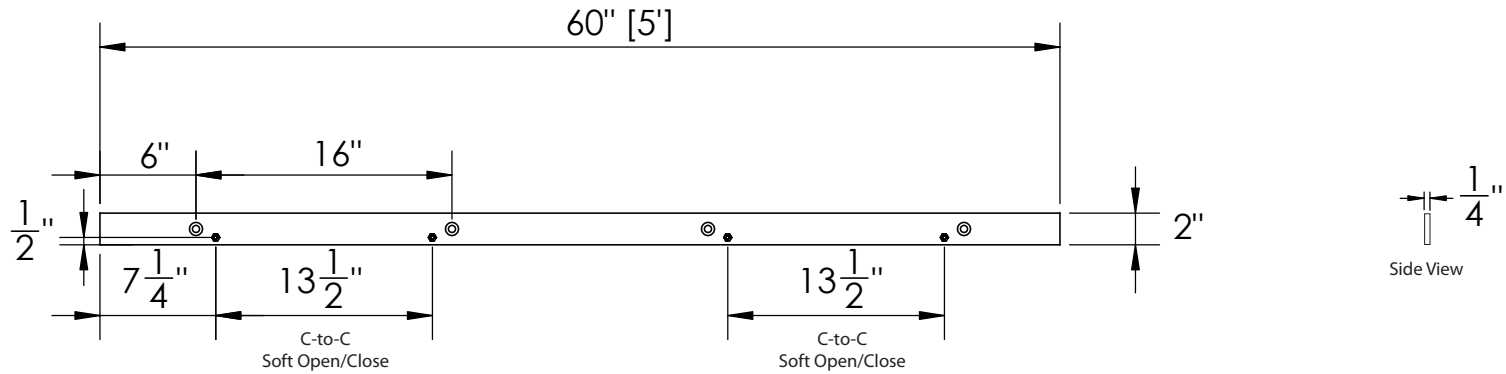

EMTEK® is a registered trademark of EMTEK®. All other trademarks are the property of their respective owners.

The wall or structure that your system will be mounted on must be designed to support a maximum door weight of 400 lbs.

# BARN DOOR HARDWARE - LOW PROFILE CONCEALED WHEEL

EMTEK®

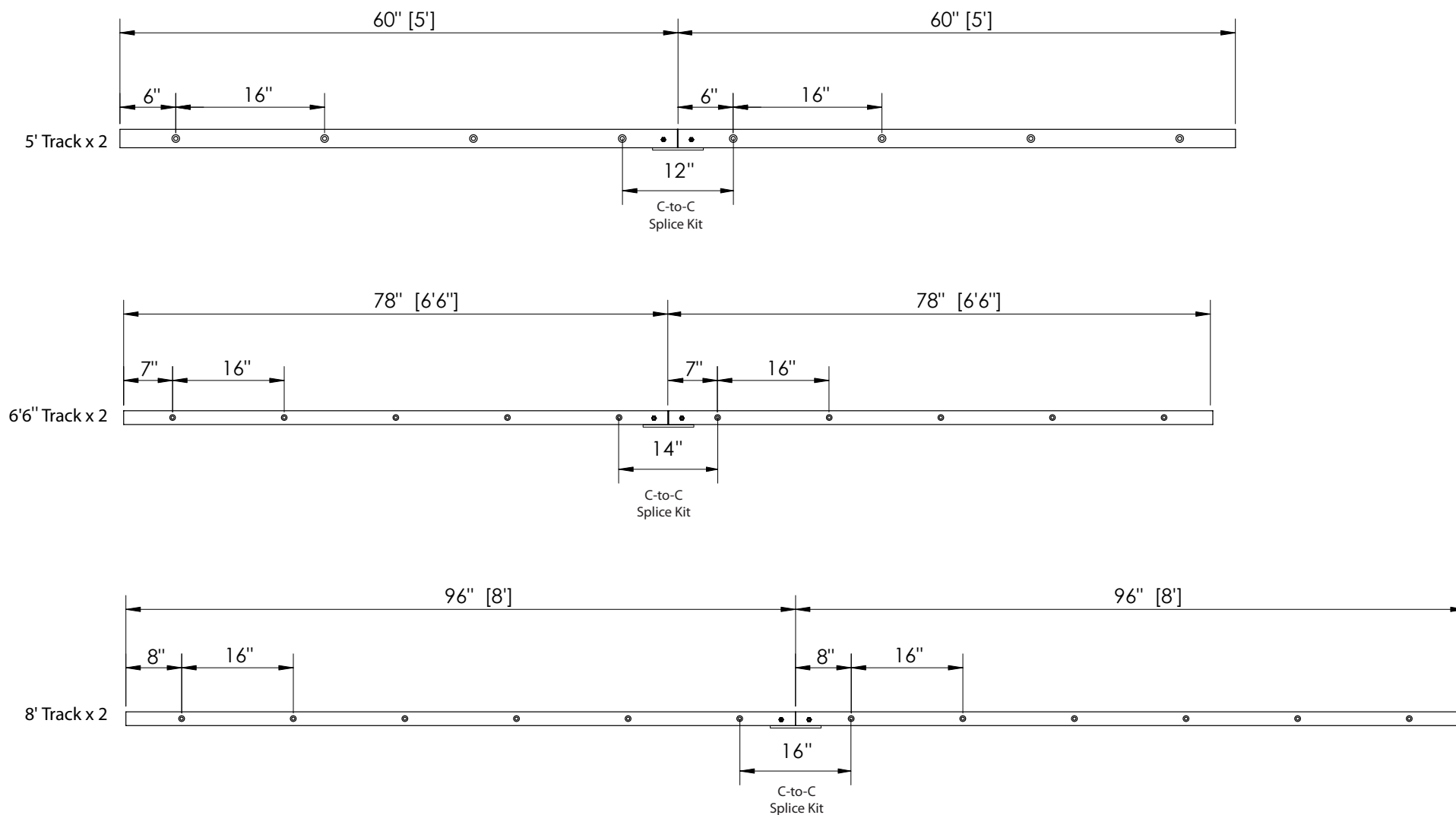

The wall or structure that your system will be mounted on must be designed to support a maximum door weight of 400 lbs.

## DOOR THICKNESS 1-3/8" to 2-1/4"\*

*\*Up to 2-3/4" thickness can be achieved with use of a counter-bore*

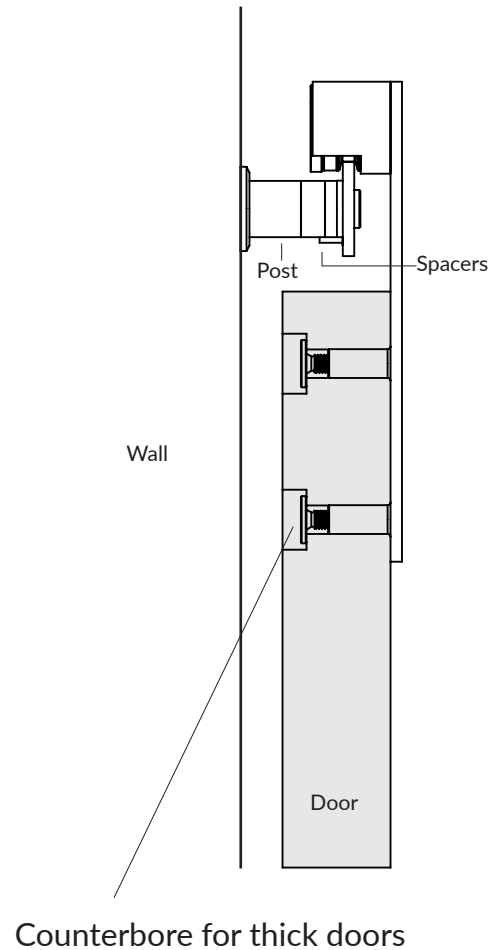

The wall or structure that your system will be mounted on must be designed to support a maximum door weight of 400 lbs.