

0117 3/4" OFFSET PIVOT SET

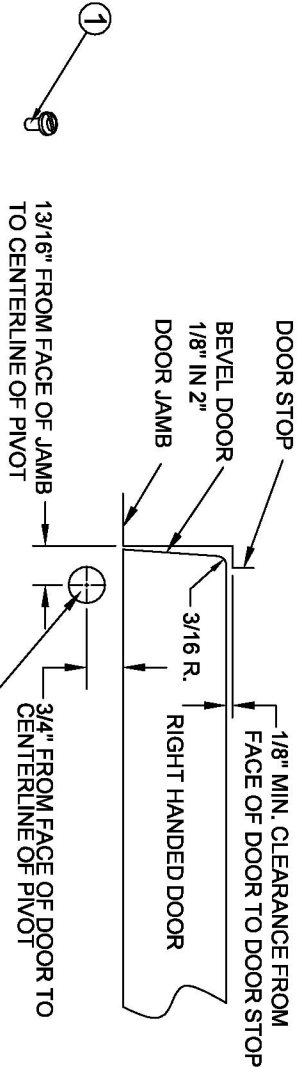

1. INSTALLING PIVOT

- A. MEASURE 13/16" OUT FROM DOOR JAMB.
- B. ALLOW 7/8" MIN CLEARANCE FROM DOOR STOP TO DOOR FACE.
- C. MEASURE DOOR THICKNESS AND ADD 3/4".
- C. WHERE THESE LINES INTERSECT DETERMINES THE CENTERLINE OF THE PIVOT.

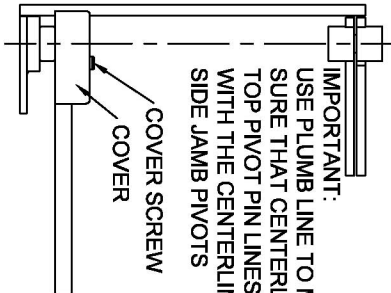
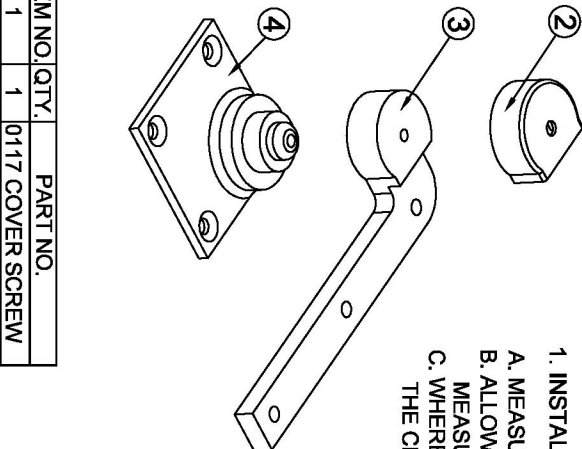

- IMPORTANT:
USE PLUMB LINE TO MAKE SURE THAT CENTERLINE OF TOP PIVOT PIN LINES UP WITH THE CENTERLINE OF SIDE JAMB PIVOTS
3. INSTALL TOP PIVOT AND PIVOT ARM
- A. INSTALL TOP PIVOT IN DOOR PER TEMPLATE.
 - B. INSTALL TOP PIVOT IN FRAME PER TEMPLATE.
 - C. INSTALL ARM IN DOOR PER TEMPLATE.
 - D. CENTERLINE OF TOP PIVOT SHOULD LINE UP WITH CENTERLINE OF PIVOT ARM. (USE PLUMB LINE AS ILLUSTRATED)
 - E. IF SIDE JAMB PIVOT IS USED, SEE REQUIRED TEMPLATE.

ITEM NO.	QTY.	PART NO.
1	1	0117 COVER SCREW
2	1	0117 ARM COVER
3	1	0117 DOOR PORTION
4	1	0117 FLOOR PORTION

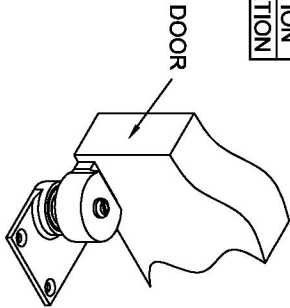

4. HANG DOOR
- A. SET DOOR ON PIVOT SET SPINDLE.
 - B. PUSH TOP PIVOT PIN IN PLACE AND TIGHTEN 0180 END CAP (ITEM #1).
 - C. PUT ARM COVER (ITEM #2) ON AND SECURE TIGHTLY WITH COVER SCREW.

2. SET PIVOT SET
- A. PREPARE FLOOR TO RECEIVE FLOOR PORTION. SET ANCHORS PROVIDED SECURELY IN FLOOR.
 - B. IMPORTANT: FLOOR PORTION MUST BE LEVEL. LEVEL IN BOTH DIRECTIONS PER ILLUSTRATION.
 - C. FLOOR PORTION SHOULD BE PARALLEL WITH CENTERLINE OF DOOR.

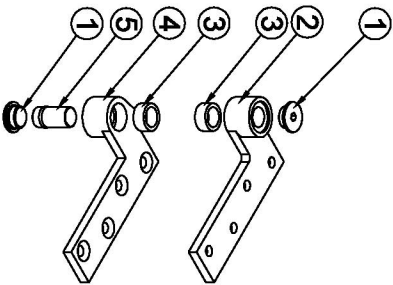
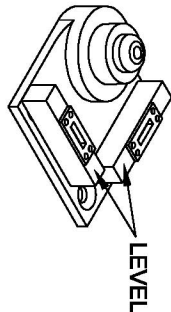

ITEM NO.	QTY.	PART NO.
1	2	0180 END CAP
2	1	0180 JAMB PORTION
3	2	0180 NEEDLE BEARING
4	1	0180 DOOR PORTION
5	1	0180 PIVOT PIN

NOTE:
AFTER TOP PIVOT INSTALLATION IS COMPLETE ITEM #1 (END CAP) MUST BE TIGHTENED SECURELY.